

Circular connector with shield connected to ring nut; single head with or without LED; color head and type of cable customized.

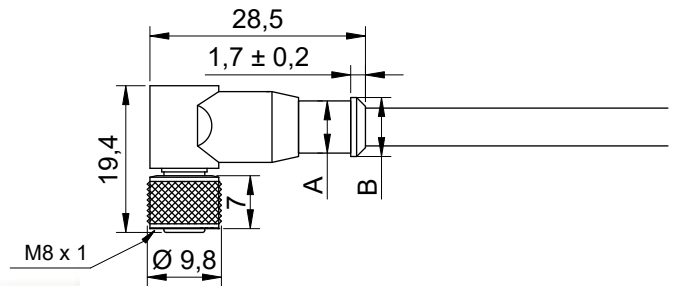
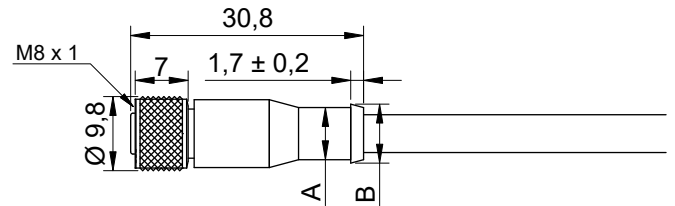

A=Ø7 - B=Ø8 with Ø cable ≤5
A=Ø8 - B=Ø9 with Ø cable >5

disegni scala 1:1

GENERAL FEATURES





contact material:
Au over Ni plated CuSn

cupling nut material:
CuZn, Ni plated

protection class:
IP67

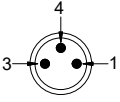
housing material:
TPU (Polyurethane)

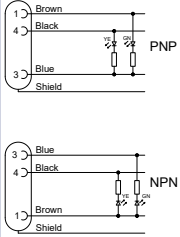
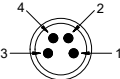
temperature range:
-25°C + 80°C

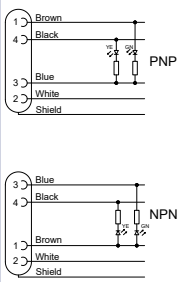
Face view	Coding/poles	Locking system	Connections	Voltage (V)	Max current (A)	Features	Housing color
	A/3	Ring nut without anti-vibration system		60	3	Without electronics	Black
				30	3	With LED electronics	
	A/4	Ring nut without anti-vibration system		60	3	Without electronics	Black
				30	3	With LED electronics	

CODING CODE

N Housing color	08S Family	FD Connector type	3 Pin no.	F Cable type	3 Section	10 Length	S Customized
N : Black G : Grey T : Colorless Y : Yellow ...	08S : Shielded M8 08SL : Shielded M8 with PNP LED 08SL2 : Shielded M8 with NPN LED ...	FD : Straight female FA : Angled female	3 : 3 pin 4 : 4 pin ...	A : Grey PVC/PVC AU : Grey PVC/PVC UL CSA B : Shielded grey PVC/PVC BU : Shielded grey PVC/PVC UL CSA E : Black PVC/PVC EU : Black PVC/PVC UL CSA F : Shielded black PVC/PVC FU : Shielded black PVC/PVC UL CSA I : Gray PUR/PVC IU : Gray PUR/PVC UL CSA M : Black PUR/PVC MU : Black PUR/PVC UL CSA N : Shielded black PUR/PVC NU : Shielded black PUR/PVC UL CSA ...	1 : Sec. 0,14 mmq 2 : Sec. 0,25 mmq 3 : Sec. 0,34 mmq 4 : Sec. 0,50 mmq ...	0A : 0,10 m 0B : 0,20 m 1Z : 1 m 10 : 10 m 10C : 10,3 m 100 : 100 m	S : Standard ...